

# THE SCHOOL DISTRICT OF OSCEOLA COUNTY, FLORIDA

817 Bill Beck Boulevard • Kissimmee • Florida 34744-4492  
Phone: 407-870-4600 • Fax: 407-870-4010 • [www.osceolaschools.net](http://www.osceolaschools.net)

## SCHOOL BOARD MEMBERS

District 1 – Teresa “Terry” Castillo  
407-577-5022  
District 2 – Kelvin Soto – Vice Chair  
407-870-4009  
District 3 – Tim Weisheyer  
407-361-0235  
District 4 – Clarence Thacker – Chair  
407-870-4009  
District 5 – Ricky Booth  
407-870-4009



Superintendent of Schools  
Dr. Debra P. Pace

## Agenda

### **Business Advisory Board Meeting**

#### **Bill Collins Conference Room**

Administrative Complex  
817 Bill Beck Boulevard  
Kissimmee, Florida

**Wednesday, December 12, 2018**

**7:30 A.M.**

1. Approve Minutes of October 24, 2018
2. Review Impact Fee & Sales Tax Report
3. Budget Update
4. Facilities Update
5. Next regular meeting: Wednesday, January 23, 2018  
@ 7:30 a.m. in the Bill Collins Conference Room

BUSINESS ADVISORY BOARD MINUTES  
OCTOBER 24, 2018

**Members Present:** Turner Wallis, Mel Welch, Robert Bass, Grant Lacerte & Shawn Hindle

**Others/Guests:** Sarah Graber, Marc Clinch, Mark Lockard, Randy Shuttera, Rhonda Blake, Maribel Vallellanes, & Luz Skerrett

Mr. Welch called the meeting to order.

**Introductions**

- **Minutes**

The minutes from the September 26, 2018, meeting were approved with all ayes.

- **Impact Fee and Sales Tax Reports**

Ms. Vallellanes reviewed the Impact Fee & Sales Tax Reports as of August 31, 2018.

**Impact Fee Revenues**

Collections **\$7M**  
Unit **488**

**Impact Fee Expenditures**

Approx. **\$3.2M**  
Majority for Tohopekaliga  
High, Middle AA and Buses

**Impact Fee Credits**

Approx. **\$2.8M** outstanding  
(Avatar & Flora Ridge EFBD)  
Decrease **\$337,000**

**Infrastructure Sales Surtax Revenue**

Collections approx. **\$2.8M**

**Infrastructure Sales Surtax Expenditures (1/4 cent)**

Approx. **\$230,00** spent for FYTD  
Majority in Buses

**School Capital Outlay Surtax Revenue**

FYTD Collections **\$5.6M**  
Increase of **11%** from last year

**School Capital Outlay Surtax Expenditures (1/2 cent)**

FYTD Expenditures approx.: **\$1M**

- Mr. Welch requested an update regarding the closing projects of Tohopekaliga High School.

- **Budget Update**

Ms. Graber updated the board on the projected student enrollment, which is under projection at 1,800 students. Ms. Graber also discussed the district's concern with health insurance costs and how it will impact the district's operational budget.

BAB Member Shawn Hindle joined the meeting.

- **Facilities Update**

Mr. Clinch & Mr. Lockard presented and reviewed various Facilities and Maintenance projects. There was discussion on the planned road access and bridge to Celebration Island Village Elementary School site. Rhonda Blake gave an update on the project's developer funding obligation payments. Mr. Clinch discussed the progress of NeoCity Academy.

Mr. Bass provided information on the Year-to-Date Sales and Inventory Report from My Florida Regional MLS.

**BAB Meeting Dates**

The Business Advisory Board has agreed to meet the 4th Wednesday of every month for their monthly meeting. The Board stated there would be no November meeting due to the holiday schedule. **The next meeting will be held on Wednesday, December 12, 2018 @ 7:30 a.m. in the Bill Collins Conference Room.**

**SDOC Business Advisory Board  
Impact Fee Revenue  
For the period ending 10/31/2018**

Impact Fee Revenue: Current and Three-Year History	Fiscal Year							
	2015 - 2016		2016 - 2017		2017 - 2018		2018 - 2019	
	Revenue	Units	Revenue	Units*	Revenue	Units*	Revenue	Units*
MONTH								
July	\$ 2,168,067	259	\$ 2,474,886	253	\$ 3,197,541	375	\$ 2,385,492	267
August	1,847,463	253	2,874,446	301	2,963,407	313	4,726,773	488
September	2,384,543	358	3,177,159	335	2,987,439	296	7,804,166	
October	2,912,821	383	2,536,646	261	2,076,217	216	1,209,139	
November	3,485,509	444	3,156,311	317	2,942,186	295		
December	3,047,440	360	2,888,904	319	4,902,215	635		
January	2,246,278	286	2,766,539	278	3,566,327	439		
February	2,862,805	343	3,495,023	390	1,180,911	118		
March	3,080,304	348	3,016,274	328	2,624,898	288		
April	3,080,131	336	4,526,549	595	3,044,872	328		
May	2,910,994	348	3,998,982	503	4,807,734	420		
June**	3,886,379	419	3,400,398	420	6,212,200	645		
<b>TOTAL</b>	<b>\$ 33,912,735</b>	<b>4,137</b>	<b>\$ 38,312,117</b>	<b>4,300</b>	<b>\$ 40,505,947</b>	<b>4,368</b>	<b>\$ 16,125,571</b>	<b>755</b>

a) Kissimmee & St. Cloud only

Impact Fee Revenue Analysis	
For Fiscal Year Ending June 30, 2019	
<b>Budget:</b>	
Final Budget: Forecasted Revenue	\$ 41,923,654
BAB Recommended Adjustment	_____
Adjusted Estimated Revenue - FY18	\$ 41,923,654

Educational Impact Fee Rates					
	Countywide			Short-Term Rental	
	Effective 8/1/2018	Prior to 8/1/2018	Increase (Decrease)	Effective 8/1/2018	Increase (Decrease)
Single Family Detached	\$ 11,823	\$ 10,147	\$ 1,676	\$ 6,264	\$ (3,883)
Townhomes	7,591	10,147	(2,556)	3,951	(6,196)
Multi-Family	11,362	6,048	5,314	7,033	985
Condominium	4,243	6,048	(1,805)	2,325	(3,723)
Mobile Home	7,672	5,973	1,699	7,672	1,699

\*Number of Units as computed based on reports received by the City of Kissimmee, City of St. Cloud, and Osceola County

\*\*Accrual

**SDOC Business Advisory Board**  
**Impact Fee Expenditures**  
**For the period ending 10/31/2018**

<b>Impact Fee Expenditures: Current and Three-Year History</b>		<b>Fiscal Year</b>		
<b>PROJECT NAME</b>	<b>2015 - 2016</b>	<b>2016 - 2017</b>	<b>2017 - 2018</b>	<b>2018 - 2019</b>
Debt Service	\$ 8,508,275	\$ 5,111,761	\$ -	\$ -
Other:				
Buses	498,235		849,052	850,948
Celebration High School Wing Addition	76,815			
Celebration High School Space Reconfiguration		693,782		
Celebration K8 Space Reconfiguration	263,214			
Central Avenue Elementary Wing Addition				
Chestnut Elementary Space Reconfiguration	69,285			
Discovery Intermediate Space Reconfiguration	268,236	883,697	633,528	
Harmony High School Wing Addition	948,670	89,319		
Hickory Tree Elementary Wing Addition				
Horizon Middle School Space Reconfiguration	433,802			
Kissimmee Middle School Space Reconfiguration	552,434			
Land				
Middle AA - Harmony Area		720,742	7,502,242	5,265,399
NeoCity Academy			631,489	578,821
Poinciana High School Wing Addition		4,852,724	1,910,466	
Renovations				
Sunrise Elementary Space Reconfiguration	74,703			
Tohopekaliga High School	746,914	23,483,798	50,803,419	2,744,359
Westside K-8 Renovation		607,467	702,517	
Subtotal Other:	\$ 3,932,308	\$ 31,331,529	\$ 63,032,713	\$ 9,439,527
<b>TOTAL</b>	<b>\$ 12,440,583</b>	<b>\$ 36,443,290</b>	<b>\$ 63,032,713</b>	<b>\$ 9,439,527</b>

**SDOC Business Advisory Board  
Outstanding Impact Fee Credits  
For the period ending 10/31/2018**

<b>Entity</b>	<b>Amount Issued</b>	<b>Redeemed</b>	<b>Balance</b>
Avatar - Countywide	\$ 8,585,695	\$ 7,745,312	\$ 840,383
ICI - Flora Ridge EFBD	4,000,000	2,175,656	1,824,344
<b>TOTAL</b>	<b>\$ 25,085,695</b>	<b>\$ 22,420,968</b>	<b>\$ 2,664,727</b>

**SDOC Business Advisory Board  
School Capital Outlay Surtax Revenue  
For the period ending 10/31/2018**

Surtax Revenue: Current and History since inception	Fiscal Year		
	MONTH	2016 - 2017	2017 - 2018
July	-	\$ 2,859,082	\$ 3,247,344
August	-	2,194,580	2,362,699
September	-	2,154,461	2,107,519
October	-	2,664,318	2,906,958
November	-	2,083,815	
December	-	2,206,964	
January	-	3,339,209	
February	\$ 1,951,205	2,495,202	
March	2,014,520	2,066,220	
April	2,912,640	3,596,735	
May	2,222,938	2,354,643	
June*	2,049,228	2,207,039	
<b>TOTAL</b>		<b>\$ 11,150,531</b>	<b>\$ 30,222,267</b>

School Capital Surtax Analysis	
For Fiscal Year Ending June 30, 2019	
<b>Budget:</b>	
Final Budget: Forecasted Revenue	\$ 31,509,016
BAB Recommended Adjustment	-
Adjusted Estimated Revenue - FY18	\$ 31,509,016

\*Accrual

**SDOC Business Advisory Board  
Infrastructure Sales Surtax Revenue  
For the period ending 10/31/2018**

Surtax Revenue: Current and Three-Year History	Fiscal Year			
	MONTH	2015 - 2016	2016 - 2017	2017 - 2018
July	\$ 909,859	\$ 1,428,859	\$ 1,432,353	\$ 1,626,416
August	1,072,805	1,046,947	1,101,673	1,187,951
September	867,329	947,552	1,081,142	1,051,985
October	1,144,236	1,255,528	1,366,944	1,460,827
November	907,822	920,847	1,044,372	
December	931,706	1,018,097	1,132,027	
January	1,455,983	1,522,982	1,649,693	
February	969,344	987,974	1,248,395	
March	1,029,625	1,011,257	1,039,021	
April	1,558,745	1,583,680	1,799,463	
May	1,029,386	1,109,801	1,179,008	
June*	894,435	1,026,513	1,107,946	
<b>TOTAL</b>	<b>\$ 12,771,275</b>	<b>\$ 13,860,037</b>	<b>\$ 15,182,037</b>	<b>\$ 5,327,179</b>

Infrastructure Sales Surtax Analysis	
For Fiscal Year Ending June 30, 2019	
<b>Budget:</b>	
Final Budget: Forecasted Revenue	\$ 15,754,508
BAB Recommended Adjustment	-
Adjusted Estimated Revenue - FY18	\$ 15,754,508

\*Accrual

**SDOC Business Advisory Board**  
**School Capital Outlay Surtax Expenditures (1/2 Cent)**  
**For the period ending 10/31/2018**

Type of Expenditure	Fiscal Year		
	2016-2017	2017-2018	2018-2019
Debt Service	\$ 136,948	\$ 2,117,995	\$ 5,910,900
Comprehensive Renovations:			
Denn John Middle School	20,694	1,318,044	51,555
Gateway High School			26,914
Michigan Avenue Elementary School	113,645	6,132,009	3,940,583
St. Cloud Middle School	24,503	11,319	258,400
<b>Subtotal Debt Service and Comprehensive Renovations</b>	<b>\$ 295,790</b>	<b>\$ 9,579,367</b>	<b>\$ 10,188,352</b>
Other:			
Carpet Replacements/Flooring:			
Celebration High School	\$ -	\$ 113,225	\$ -
Central Elementary School	199,992		
Cypress Elementary School	150,000		
Discovery Intermediate School			55,418
Gateway High School		56,883	
Harmony High School	134,345		
Hickory Tree Elementary School	175,762		
Horizon Middle School	57,471		
Narcoossee Middle School	85,119	25,400	
Neptune Middle School		325,215	
Pleasant Hill Elementary School		320,741	
Poinciana Academy of Fine Arts	152,325	94,691	
Reedy Creek Elementary School	273,427	343	
Ventura Elementary School	315,274		
Chiller Replacements:			
Celebration K-8 School	165,020	688,956	
Horizon Middle School	286,509	83,172	
Kissimmee Middle School	190,700	147,998	66,253
Poinciana Academy of Fine Arts			2,100
Poinciana High School		96,113	3,920
HVAC Repairs/Replacements:			
Celebration High School		148,219	37,863
Discovery Intermediate School		281,578	
Harmony Community	23,497		
Hickory Tree Elementary School	14,455		
Kissimmee Elementary School		119,882	11,040
Kissimmee Middle School			66,487
Liberty High School			55,400
Neptune Middle School		8,793	3,002
oTECH		7,482	5,524
Ross E. Jeffries Campus	8,840	6,040	
Fencing:			
Boggy Creek Elementary School		3,114	2,221
Celebration High School		740	833
Celebration K-8 School			1,280
Central Elementary School		2,807	3,608
Harmony Community School			33,086
Harmony High School		2,645	
Highlands Elementary		1,852	36,156
Lakeview Elementary School		1,756	53
Liberty High School	8,198		
Narcoossee Middle School		3,072	2,160
Neptune Middle School		48,596	



Type of Expenditure	2016-2017	2017-2018	2018-2019
St. Cloud High School		10,900	107
Sunrise Elementary School		6,568	
Osceola County School for the Arts	19,245		
Westside K-8			36,355
Fire Alarms:			
Partin Settlement Elementary School	31,298		
Poinciana Academy of Fine Arts	7,015	23,776	
Painting and/or other repairs:			
Boggy Creek Elementary School	3,715		
Celebration K-8 School	153,714	3,553	
Central Elementary School	35,120	55,858	
Chestnut Elementary School		22,930	
Cypress Elementary School		25,761	
Discovery Intermediate School		99,037	67,185
Flora Ridge Elementary School	29,806		
Gateway High School		12,971	757
Harmony Community School		39,935	
Harmony High School	247,400	66,648	
Hickory Tree Elementary School	17,133	72,440	21,008
Horizon Middle School	54,287	56,091	
Kissimme Elementary School		32,467	
Kissimmee Middle School	27,270	50,630	149,558
KOA Elementary		45,486	
Lakeview Elementary School	2,091	1,613	
Liberty High School	71,922	136,128	
Narcoossee Elementary School		44,500	
Narcoossee Middle School		129,279	
Neptune Elementary School	50,269	33,755	
Neptune Middle School	33,559	8,700	
New Beginnings		24,187	
Osceola County School for the Arts			6,624
Parkway Middle School	5,224	22,905	
Partin Settlement Elementary School		1,649	
Pleasant Hill Elementary School		80,632	
Poinciana Academy of Fine Arts	46,424	23,284	
Reedy Creek Elementary School			32,012
Ross E. Jeffries Campus		6,495	
St. Cloud Elementary School	9,988	26,774	
Sunrise Elementary School		74,684	
Ventura Elementary School		123,984	
Parking Lot Resurface / Bus Loop / Concrete:			
Boggy Creek Elementary School		80,052	
Chestnut Elementary		6,818	
Transportation		93,864	
Renovations:			
Gateway High School	5,194	23,461	
Roofing/Gutters/Covered walkways:			
Celebration K-8 School	31,923	945,999	
Chestnut Elementary			61,800
Deerwood Elementary School	9,068	107,771	
Gateway High School		19,880	
Hickory Tree Elementary School		883	
Narcoossee Middle School			12,500
Sunrise Elementary School			64,200
Safety & Security Equipment		193,808	391,345
Security Modifications		129,378	
Technology Infrastructure	1,422,045	838,476	89,261
<b>Subtotal Other</b>	<b>4,554,644</b>	<b>6,393,323</b>	<b>1,319,116</b>
<b>TOTAL</b>	<b>\$ 4,850,434</b>	<b>\$ 15,972,690</b>	<b>\$ 11,507,468</b>

**SDOC Business Advisory Board  
Infrastructure Sales Surtax Expenditures (1/4 Cent)  
For the period ending 10/31/2018**

Sales Tax Expenditures: Current and Three Year History		Fiscal Year		
Type of Expenditure	2015-2016	2016-2017	2017-2018	2018-2019
Debt Service	\$ 6,881,502	\$ 6,938,488	\$ 6,529,728	\$ (130)
Other:				
Athletic Facilities	\$ 366,452	\$ 10,665	\$ 6,939	\$ 889
Bathroom Renovations				
Buildings	16,406	183,968	33,477	
Buses			1,970,730	114,952
Chiller Replacements		54,421	544,772	
Communications	1,370,450	4,355		
Land Purchase		3,400		
Remodeling	488,224	154,604	960,535	260,442
Renovations		5,926		
Rent/Purchase Portables	376,267			
Retrofit	1,224,623	162,942		
Roofing				
School Computers	6,130			
Shade Cover				
Signage				
Site improvements				12,324
Technology			888	154,375
White Fleet			86,400	50,667
Subtotal Other:	\$ 3,848,552	\$ 580,281	\$ 3,603,741	\$ 593,649
<b>TOTAL</b>	<b>\$ 10,730,054</b>	<b>\$ 7,518,769</b>	<b>\$ 10,133,469</b>	<b>\$ 593,519</b>



# Osceola School District

*From Good to Great: Building a Legacy*



December 12, 2018

***Business Advisory Board Meeting – Facilities Update***



# Agenda

## Planning Department Update

- a. School and Ancillary Sites
- b. Site Visits – School Utilization

## Design & Construction Department Update

- a. Projects in Planning
- b. Projects in Design
- c. Projects in Construction
- d. NeoCity Academy Update

## Deferred Maintenance – Sales Tax Project Update



# Planning Department Update

## Verbal Updates:

- School and Ancillary Sites
- Site Visits – School Utilization



# Projects in Planning

4

Project	Budget	Proposed Opening
CAES Cafeteria Décor Project	\$75,000	2019
KMES Cafeteria Décor Project	\$75,000	2019
Old Hickory Tree New ES	\$26,916,559	2022-2023
K-8 Kindred "AA"	\$42,779,358	2022-2023
oTECH Paving	\$488,333	2019
oTECHW Safety/Security Upgrades	\$25,663	2019
2018/2019 Cyclical Capital Projects	\$1,343,148	TBD
GWHS Comprehensive Renovation	\$TBD	TBD
<b>TOTAL</b>	<b>\$71,703,061</b>	



# Projects in Design

5

Project	Budget	Construction Notice to Proceed
NPMS Rear Bus Loop	\$500,000	TBD – Project ON Hold
SCMS Comprehensive	\$32,973,602	11/16/2020
Celebration ES “A”	\$25,380,061	6/9/2020
Kitchen Serving Line (4 Projects)	\$7,111,410	7/26/2019
Space Reconfiguration (6 Projects)	\$929,513	7/26/2019
PNHS Chiller Replacement	\$2,704,335	6/18/2019
LBHS Site Traffic Pattern	\$903,355	9/17/2018
DWES Parking Resurfacing	\$366,193	1/21/2019
HRHS Kitchen Generator	\$417,631	11/12/2018
HRHS Parking Lot Repair	\$159,259	8/1/2019
LBHS Kitchen Generator	\$417,631	11/12/2018
KMMS Kitchen Generator	\$573,043	11/12/2018
HLES Cafeteria Decore	\$75,000	8/02/2019
KMMS Mini-Pitch	By Others	12/14/2019
Safety Security (2 Projects)	\$40,000	1/7/2019
Cyclical Capital (6 Projects)	\$660,510	TBD
<b>TOTAL</b>	<b>\$73,211,540</b>	



# Projects in Construction

6

Project	Budget	Substantial Completion Date
MAES Comprehensive	\$31,186,354	8/30/2019
DJMS Comprehensive	\$43,085,803	12/17/2019
HRHS Ag Building	\$521,060	11/9/2018
Tohopekaliga HS	\$89,000,000	6/14/2018
HRMS New School	\$40,279,258	10/25/2019
oTECH St Cloud Diesel Mech	\$1,585,014	12/30/2018
Maintenance Bldg Renovation	\$970,000	5/20/2019
NeoCity Academy	\$18,000,000	7/15/2019
PWMS Lighting/HVAC	\$437,931	10/15/2018
OCSA Generator	\$90,793	10/31/2018
BELA Shade Structure	\$38,601	12/21/2018
DSCV Lobby Flooring	\$10,415	1/11/2019
Security Fencing (4 Projects)	\$252,509	TBD
Cyclical Capital Projects (12)	\$1,482,084	TBD
<b>TOTAL</b>	<b>\$226,939,822</b>	





# Tohopekaliga High School



New High School FFF

Image # 91  
Date : 07.27.2018  
Photo 888.542.0231





# MAES Comprehensive



727.520.8181  
www.aerophoto.com

Michigan Avenue ES

Image # 57  
Date 11.28.18





# Harmony Middle School



Middle School AA  
Harmony, FL  
11.29.18  
Looking East







# Denn John Middle School Comprehensive



Denn John Middle School  
Comprehensive Renovation Project  
10-19-18







# St. Cloud Middle School Comprehensive







# NeoCity Academy

12

## RENDERINGS

VIEW LOOKING AT MAIN ENTRANCE







# NeoCity Academy

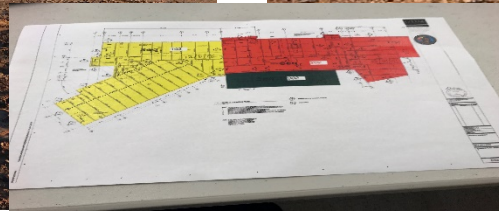



# Deferred Maintenance/Sales Tax

14

Project	Budget	Substantial Completion Date
CLHS Trash Compactor	\$20,000	12/3/2018
CK8S Controls	\$175,000	4/29/2019
DIMS Trash Compactor	\$20,000	12/3/2018
HZMS Trash Compactor	\$20,000	12/3/2018
LBHS Controls	\$325,000	2/1/2019
LBHS Trash Compactor	\$20,000	12/3/2018
WK8S Trash Compactor	\$20,000	12/3/2018
<b>TOTAL</b>	<b>\$600,000</b>	

**More projects in Planning for Spring Break time-frame**





# **Business Advisory Board Comments and Discussion**

*From Good to Great: Building a Legacy*



**Osceola Association of Realtors®**  
**Four Year Sales and Inventory History 2014 - 2018**  
 Compiled from Monthly Sales and Inventory Reports

Month	Monthly Sales	Average List Price	Average Sale Price	% Diff Sell/List	Avg DOM	Current Inventory	Months Inventory
11/1/2014	481	173,191	165,621	96%	90	4,288	8.9
12/1/2014	576	177,704	171,826	97%	91	4,160	7.2
1/1/2015	432	163,668	157,306	96%	89	4,057	9.4
2/1/2015	490	162,507	155,864	96%	88	4,034	8.2
3/1/2015	634	180,674	174,986	97%	87	4,047	6.4
4/1/2015	614	179,877	174,998	97%	94	3,997	6.5
5/1/2015	631	173,156	166,959	96%	81	3,998	6.3
6/1/2015	694	184,857	177,233	96%	81	4,038	5.8
7/1/2015	637	179,127	171,664	96%	79	3,987	6.3
8/1/2015	665	183,523	177,401	97%	88	3,931	5.9
9/1/2015	615	186,612	178,760	96%	78	3,882	6.3
10/1/2015	606	176,601	170,456	97%	85	3,763	6.2
11/1/2015	479	181,348	175,360	97%	80	3,803	7.9
12/1/2015	553	186,947	181,011	97%	75	3,716	6.7
1/1/2016	402	180,820	171,495	95%	92	3,577	8.9
2/1/2016	471	189,405	182,435	96%	88	3,672	7.8
3/1/2016	535	186,879	180,499	97%	88	3,604	6.7
4/1/2016	663	191,528	185,315	97%	86	3,504	5.3
5/1/2016	663	195,302	188,413	96%	76	3,437	5.2
6/1/2016	615	199,536	190,261	95%	82	3,500	5.7
7/1/2016	597	189,953	183,442	97%	80	3,420	5.7
8/1/2016	631	203,035	192,787	95%	82	3,449	5.5
9/1/2016	580	190,151	183,856	97%	79	3,517	6.1
10/1/2016	516	200,682	192,644	96%	73	3,408	6.6
11/1/2016	516	198,367	190,464	96%	76	3,409	6.6
12/1/2016	568	199,585	192,613	97%	76	3,284	5.8
1/1/2017	430	198,662	189,822	96%	77	3,221	7.5
2/1/2017	489	195,701	189,366	97%	83	3,156	6.5
3/1/2017	628	212,628	205,395	97%	77	3,108	4.9
4/1/2017	598	213,445	205,462	96%	77	3,036	5.1
5/1/2017	688	209,293	202,944	97%	67	3,014	4.4
6/1/2017	681	222,956	213,659	96%	75	3,074	4.5
7/1/2017	587	212,807	204,666	96%	72	2,979	5.1
8/1/2017	591	213,702	204,935	96%	66	2,995	5.1
9/1/2017	438	220,263	211,639	96%	67	2,835	6.5
10/1/2017	515	206,822	199,025	96%	75	2,720	5.3
11/1/2017	538	228,935	220,727	96%	85	2,647	4.9
12/1/2017	530	222,902	216,499	97%	81	2,478	4.7
1/1/2018	454	217,444	210,128	97%	69	2,362	5.2
2/1/2018	455	220,855	213,480	97%	80	2,221	4.9
3/1/2018	599	228,184	220,004	96%	69	2,060	3.4
4/1/2018	628	226,400	219,237	97%	72	2,047	3.3
5/1/2018	676	238,173	231,111	97%	62	1,971	2.9
6/1/2018	682	238,697	232,540	97%	58	1,990	2.9
7/1/2018	599	232,601	225,220	97%	56	1,979	3.3
8/1/2018	672	233,582	225,776	97%	64	2,024	3.0
9/1/2018	551	238,609	231,701	97%	57	2,014	3.7
10/1/2018	651	232,245	226,471	98%	55	2,066	3.2